

**SPECIFICATIONS**

CONTACT RATING: 6A @125 VAC or 28 VDC  
 3A @ 250VAC  
 ELECTRICAL LIFE:50,000 make-and-break cycles at full load  
 CONTACT RESISTANCE: 10 mΩ max. initial @2-4 VDC,100 mA  
 INSULATION RESISTANCE: 1,000 MΩ min.  
 DIELECTRIC STRENGTH: 1,500 V RMS @ sea level.  
 OPERATING TEMPERATURE: -30°C to +85°C

**MATERIALS**

CASE - diallyl phthalate ( DAP )  
 PLUNGER - Glass filled nylon or glass filled polyester  
 BUSHING - Copper alloy , nickel plated  
 HOUSING - Stainless Steel  
 CONTACT AND TERMINAL - Copper alloy , silver plated

How do you build the switches you need!!

The straight type please see the (A) ; The right angle P.C.B termination, please see the (B)

(A) L 8 6 0 1 - C V 1 - 2 - E B R - E - S 2 0 -

Switches Function		Cap or Actuator		Cap color		Bushing		Epoxy seal		Vertical support Bracket	
L8601	SPDT on-on	none	(none)	1	white	E	Thd /key-way(Std.)	(none)	none seal	(none)	
L8602	DPDT on-on	CV	5.08	2	black	M	Non-thd / key-way	E	epoxy seal	S20	11.68
L8603	SPDT on-mom	CV1	7.70	3	red	F	Thd / flat			S25	16.00
		CV2	9.53	4	orange	N	Non-thd /flat			S35	11.68
		CV4	dress nut	5	yellow					S40	16.00
		CV5	9.90	6	green					V20	snap-in 11.68
		CV6	9.80	7	blue					V25	snap-in 16.00
		F22A	With frame	8	gray					V35	snap-in 11.68
		F32A	With frame and LED	9						V40	snap-in 16.00
		<b>Plunger</b>				<b>Termination</b>					
		(none)	STD.			B	solder lug				
		M	Metal			C	P.C 1.27width				
		M1	Metal (Snap - fitting)			D	Quick connect				
						D1	wire wrap 19.05				
						D3	wire wrap 10.8				
						<b>Contact Material</b>					
						Q	silver plated				
						R	gold plated				
						G	gold over silver				
										<b>RoHS code</b>	
										H = RoHS Compliant	

(B) L 8 6 0 1 P - C V 1 - 2 - M R - E -

Horizon Right Angle	Vertical Right Angle	Switches Function	Cap		Cap color		Bushing		Epoxy seal	
L8601P	L8601L	SPDT on-on	none	(none)	1	white	M	Non thd./ key-way	(none)	none seal
L8602P	L8602L	DPDT on-on	CV	5.08	2	black	N	Non Thd / flat	E	epoxy seal
L8603P	L8603L	SPDT on-mom	CV1	7.70	3	red	E	Thd /key-way		
			CV2	9.53	4	orange	F	Thd / flat		
			CV5	9.90	5	yellow				
			CV6	9.80	6	green				
					7	blue				
					8	gray				
					9					
			<b>Plunger</b>				<b>Contact Material</b>			
			(none)	STD.			Q	silver plated		
			M	Metal			R	gold plated		
			M1	Metal (Snap - fitting)			G	gold over silver		
									<b>Support Bracket type</b>	
									(none)	std. straight type
									S	snap-in type
									<b>RoHS code</b>	
									H = RoHS Compliant	

SPDT



Model No.	Switching position	
L8601	on	on
L8603	on	mom
Term. Comm.	2-3	2-1

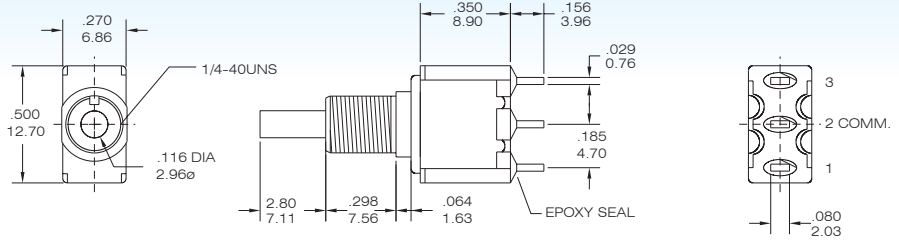
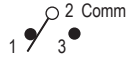

L8601-EBR-E

SPDT



Model No.	Switching position	
L8601P	on	on
L8603P	on	mom
Term. Comm.	2-3	2-1

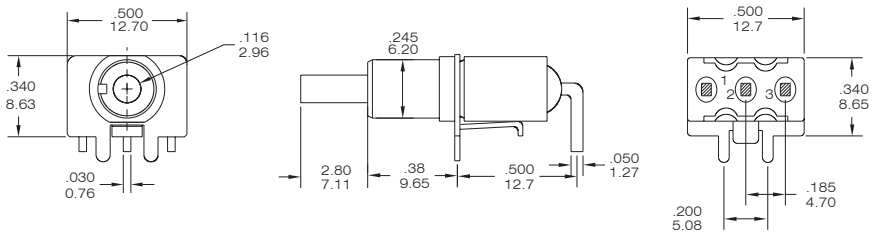
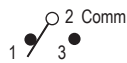

L8601P-MR-E

SPDT



Model No.	Switching position	
L8601L	on	on
L8603L	on	mom
Term. Comm.	2-3	2-1

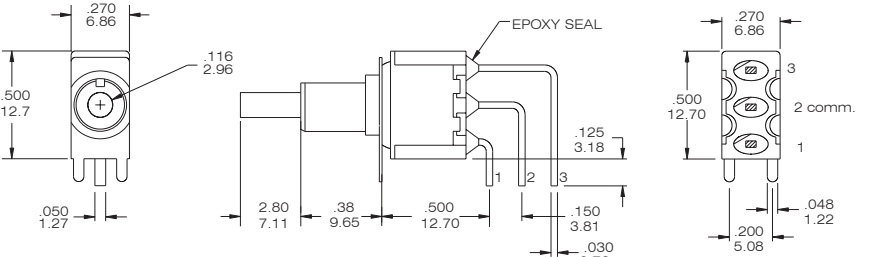

L8601L-MR-E

DPDT



Model No.	Switching position	
L8602	on	on
Term. Comm.	2-3 5-6	2-1 5-4

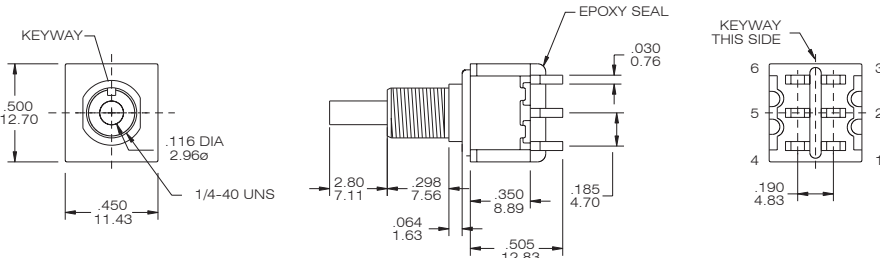

L8602-EBR-E

DPDT



Model No.	Switching position	
L8602P	on	on
Term. Comm.	2-3 5-6	2-1 5-4

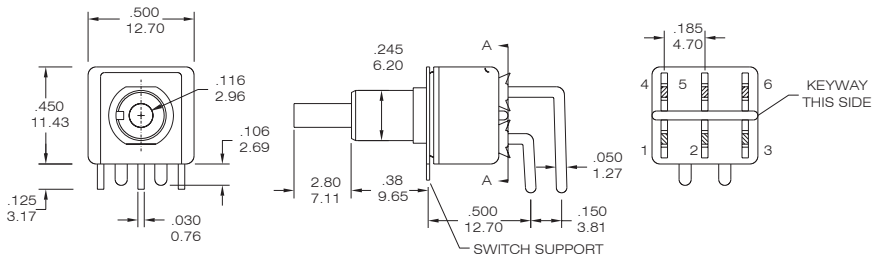

L8602P-MR-E

DPDT



Model No.	Switching position	
L8602L	on	on
Term. Comm.	2-3 5-6	2-1 5-4

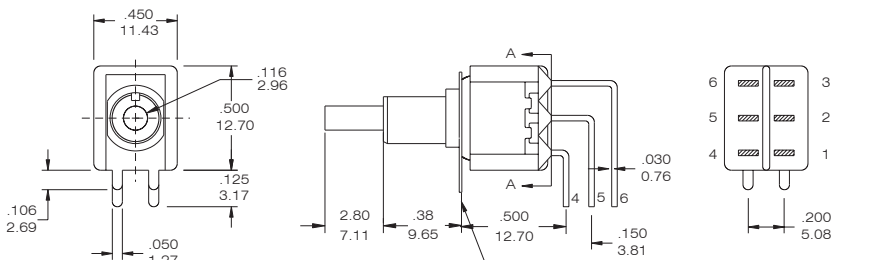

L8602L-MR-E

INDEX

TOGGLE

ROCKER

SLIDE

PUSHBUTTON

DIP

TACT

Cap and Actuator Option

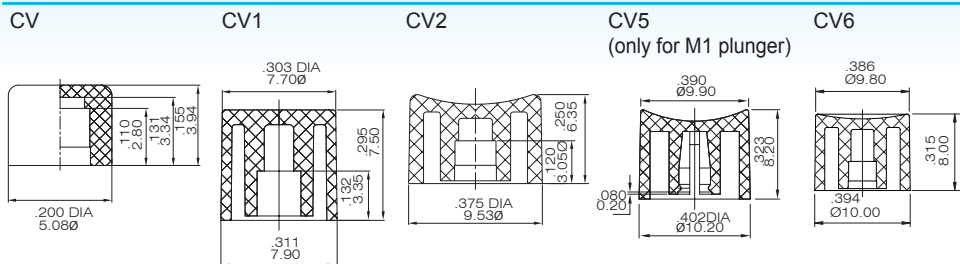

CAP & ACTUATOR OPTIONS	
1	White
2	Black(Std.)
3	Red
4	Orange
5	Yellow
6	Green
7	Blue
9	Gray



F22A

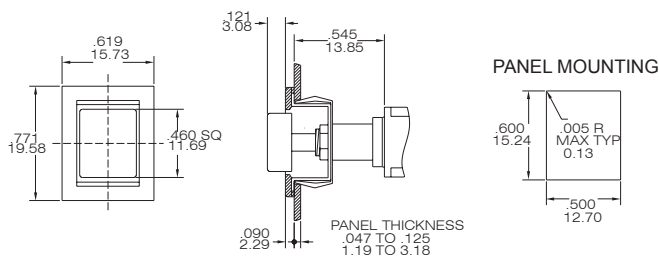

L860 \* -F22A- \* -BR-E

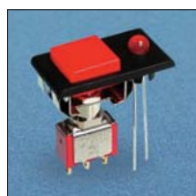

F32A

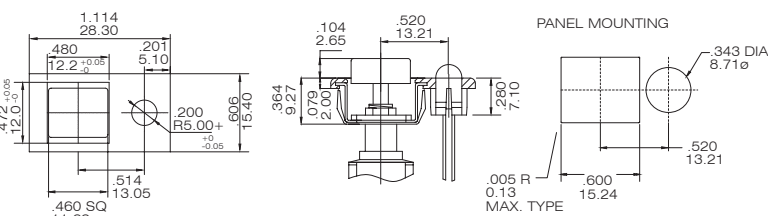

L860 \* -F32A- \* -BR-E

Panel Mounting

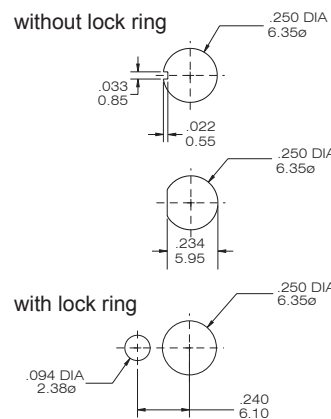

Plunger Option

Bushing Option

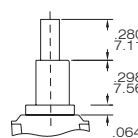
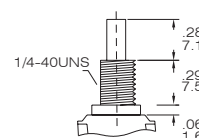
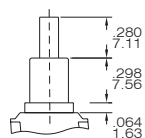
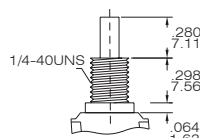
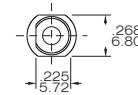
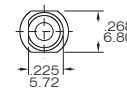
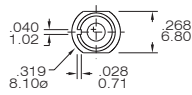
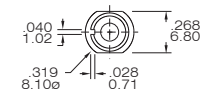
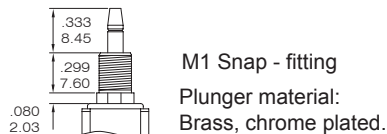
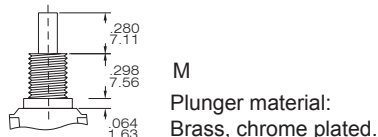
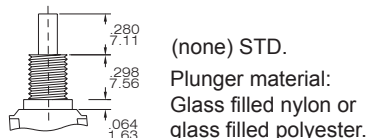

TERMINAL OPTION (ONLY FOR THE STRAIGHT TYPE L8601~L8602)

TERMINAL SEAL OPTION

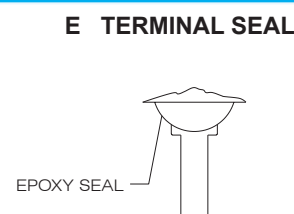
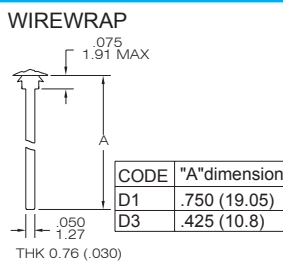
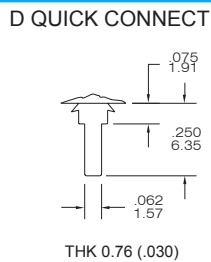
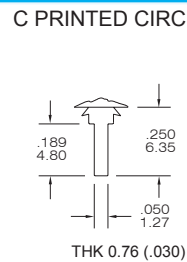
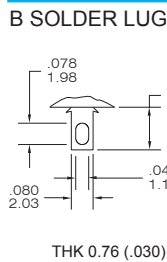

CONTACT MATERIAL OPTIONS

CODE	CONTACT MATERIAL	TERMINAL MATERIAL	RATING
Q	Silver plated	Silver plated	6A @ 125VAC or 28 VDC ; 3A @ 250 VAC
R	Gold plated over nickel plated	Gold plated over nickel plated	0.4 VA MAX @ 20VAC or DC MAX
G	Gold plated over silver plated	Gold plated over silver plated	0.4 VA MAX @ 20 VAC or DC MAX or 6A @ 125VAC or 28 VDC ; 3A @ 250 VAC

**VERTICAL SUPPORT BRACKET OPTION**

( only apply the straight type terminal . Please choose the terminal option in "c" code)

S20 / S25 / V20 / V25

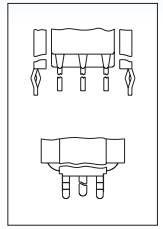
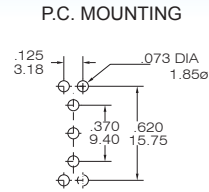
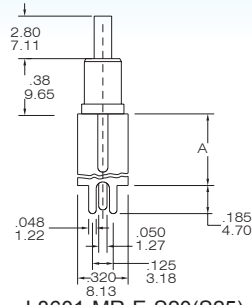
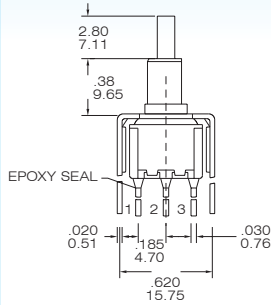

SNAP-IN  
V20/ V25

L8601-MR-E-S20(S25)

option Code	A dimension
S20/V20	.460 11.68
S25/V25	.630 16.00
V20/V25: the snap-in type	

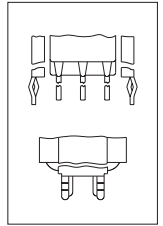
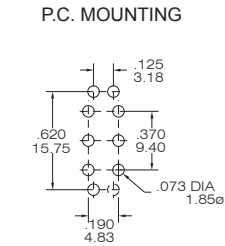
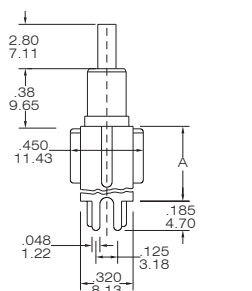
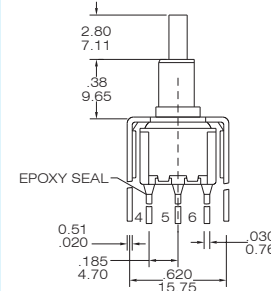

SNAP-IN  
V20/ V25

L8602-MR-E-S20(S25)

S35 / S40 / V35 / V40

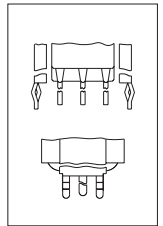
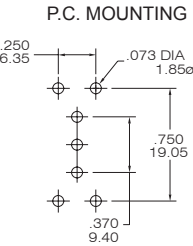
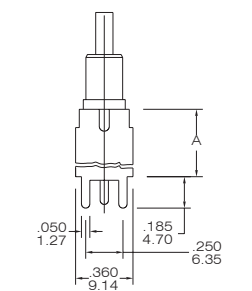
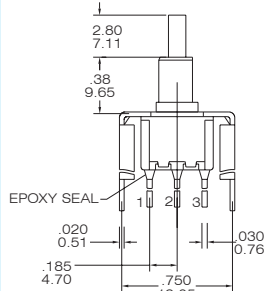

SNAP-IN  
V35/ V40

L8601-MR-E-S35(S40)

option Code	A dimension
S35/V35	.460 11.68
S40/V40	.630 16.00
V35/V40 : the snap-in type	

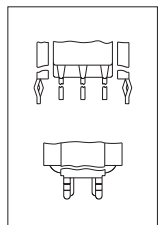
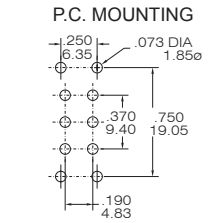
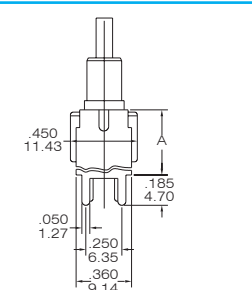
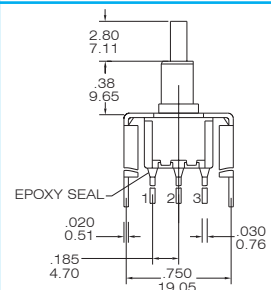

SNAP-IN  
V35/ V40

L8602-MR-E-S35(S40)

**The P.C.B mounting Dimensions**

L8601P

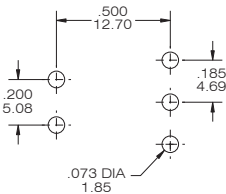

L8602P

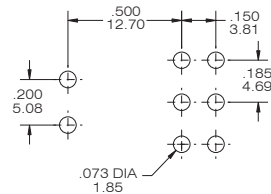

L8601L

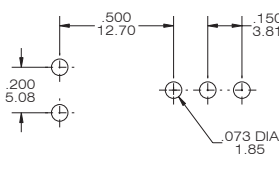

L8602L

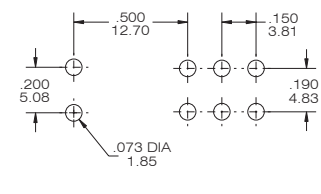

**The hard ware of T80-L push button switches**

STD.

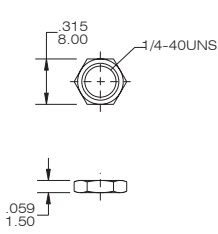

DRESS NUT

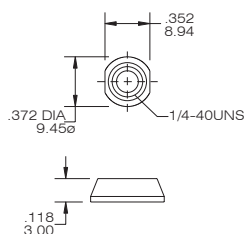

STD.

