

SPECIFICATIONS

CONTACT RATING:Q: 3A @120 VAC or 28 VDC (Q: terminal option)
 ELECTRICAL LIFE:30,000 make-and-break cycles at full load
 CONTACT RESISTANCE: 20 mΩ max. initial @2-4 VDC,100 mA
 INSULATION RESISTANCE: 1,000 MΩ min.
 DIELECTRIC STRENGTH: 1,500 V RMS @ sea level.
 OPERATING TEMPERATURE: -30°C to +85°C

MATERIALS

CASE - diallyl phthalate (DAP)(UL94V-0)
 ACTUATOR- Nylon , black standard
 BUSHING - Copper alloy , nickel plated
 HOUSING - Stainless Steel
 CONTACT AND TERMINAL - Copper alloy, silver plated
 SWITCH SUPPORT - Copper alloy , tin-plated

How do you build the switches you need!!

The RS-4 / RS-5 , please see the (A) ;

The RS-6/RS-7/RS-8/RS-9, please see the (B)

(A) RS - 4 - R 1 - 2 - C Q - E - A 5 S -

Switches Function		Actuator		Actuator Color		Termination		Epoxy seal		RoHS code	
RS-4	SP on-none-on	R1	7.62 width	1	white	B	solder lug	(none)	none seal	H = RoHS Compliant	
RS-4B	SP on-none-(on)	R2	5.84 width	2	Black	C	P.C	E	epoxy seal		
RS-4A	SP on-off-on	R3	5.76 width	3	Red	D	wire wrap				
RS-4H	SP (on)-off-(on)			The other color is available for special inquires							
RS-4I	SP on-off-(on)										
RS-5	DP on-none-on										
RS-5B	DP on-none-(on)										
RS-5A	DP on-off-on										
RS-5H	DP (on)-off-(on)										
RS-5I	DP on-off-(on)										
RS-5C	DP on-on-on										
				Marking		Contact Material		Vertical support Bracket			
				(none) No marking		Q silver plated		(none)			
				1		R gold plated		A5		straight type	
				2		G gold over silver		A5S		snap-in type	
				3		K gold / tin					
				4							
				5							

(B) RS - 6 - R 2 - 2 - Q - E - S -

Horizon Right Angle		Vertical Right Angle		Switches Function		Actuator		Contact Material		Epoxy seal		RoHS code	
RS-6	RS-8	SP	on-none-on	R1	7.62 width	Q	silver plated	(none)	none seal	H = RoHS Compliant			
RS-6B	RS-8B	SP	on-none-(on)	R2	5.84 width	R	gold plated	E	epoxy seal				
RS-6A	RS-8A	SP	on-off-on	R3	5.76 width								
RS-6H	RS-8H	SP	(on)-off-(on)			Actuator Color							
RS-6I	RS-8I	SP	on-off-(on)			1 white							
RS-7	RS-9	DP	on-none-on			2 Black							
RS-7B	RS-9B	DP	on-none-(on)			3 Red							
RS-7A	RS-9A	DP	on-off-on			The other color is available for special inquires							
RS-7H	RS-9H	DP	(on)-off-(on)										
RS-7I	RS-9I	DP	on-off-(on)										
RS-7C	RS-9C	DP	on-on-on										
						Marking							
						(none) No marking							
						1							
						2							
						3							
						4							
						5							
										Support Bracket			
										(none)		std. straight snap-in type	
										S			

SPDT

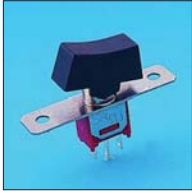

Model No.	Switching position		
RS-4	ON	none	ON
RS-4A	ON	OFF	ON
RS-4B	ON	None	(ON)
RS-4H	(ON)	OFF	(ON)
RS-4I	ON	OFF	(ON)
Term. Comm.	2-3	open	2-1

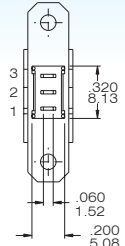
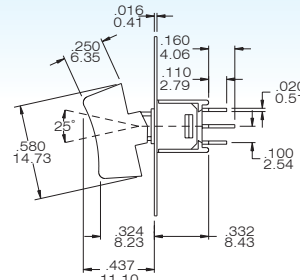
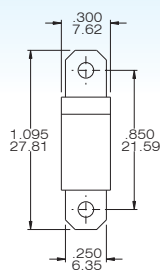

RS-4 - R1-2-BQ

DPDT

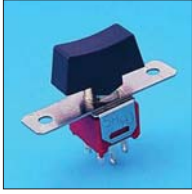

Model No.	Switching position		
RS-5	ON	none	ON
RS-5A	ON	OFF	ON
RS-5B	ON	None	(ON)
RS-5H	(ON)	OFF	(ON)
RS-5I	ON	OFF	(ON)
Term. Comm.	2-3,5-6	open	2-1,5-4
3 way switches (SP3T)			
RS-5C	ON	ON	ON
Term. Comm.	2-3,5-6	2-3,5-4	2-1,5-4

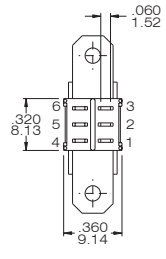
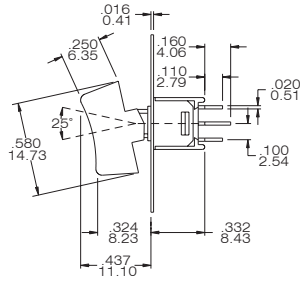
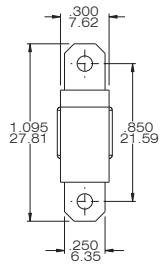

RS-5 - R1-2-BQ

SPDT



Model No.	Switching position		
RS-6	ON	none	ON
RS-6A	ON	OFF	ON
RS-6B	ON	None	(ON)
RS-6H	(ON)	OFF	(ON)
RS-6I	ON	OFF	(ON)
Term. Comm.	2-3	open	2-1

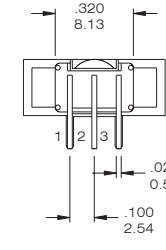
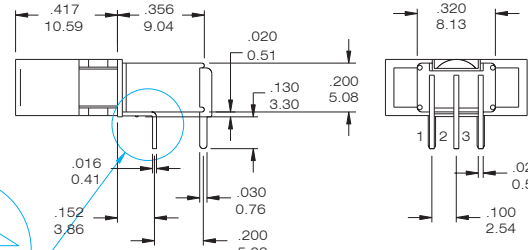
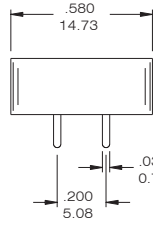

RS-6 - R2-2-Q / RS-6-R2-2-Q-S

DPDT



Model No.	Switching position		
RS-7	ON	none	ON
RS-7A	ON	OFF	ON
RS-7B	ON	None	(ON)
RS-7H	(ON)	OFF	(ON)
RS-7I	ON	OFF	(ON)
Term. Comm.	2-3,5-6	open	2-1,5-4
3 way switches (SP3T)			
RS-7C	ON	ON	ON
Term. Comm.	2-3,5-6	2-3,5-4	2-1,5-4

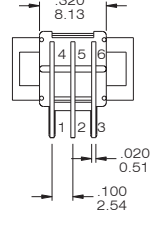
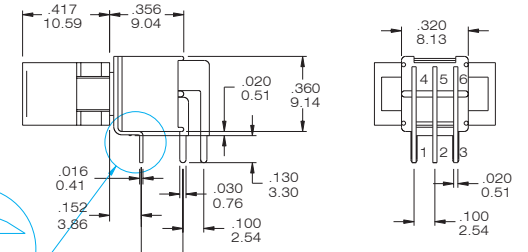
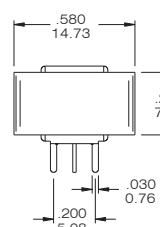

RS-7 - R1-2-Q / RS-7-R1-2-Q-S

SPDT



Model No.	Switching position		
RS-8	ON	none	ON
RS-8A	ON	OFF	ON
RS-8B	ON	None	(ON)
RS-8H	(ON)	OFF	(ON)
RS-8I	ON	OFF	(ON)
Term. Comm.	2-3	open	2-1

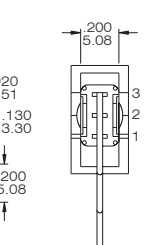
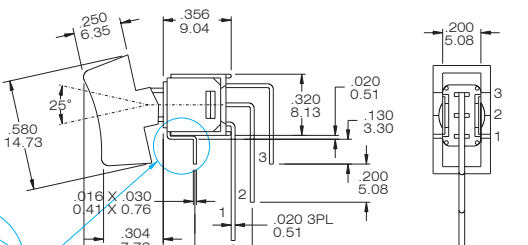
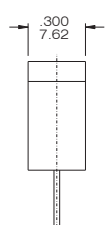

RS-8 - R1-2-Q / RS-8-R1-2-Q-S

DPDT



Model No.	Switching position		
RS-9	ON	none	ON
RS-9A	ON	OFF	ON
RS-9B	ON	None	(ON)
RS-9H	(ON)	OFF	(ON)
RS-9I	ON	OFF	(ON)
Term. Comm.	2-3,5-6	open	2-1,5-4
3 way switches (SP3T)			
RS-9C	ON	ON	ON
Term. Comm.	2-3,5-6	2-3,5-4	2-1,5-4

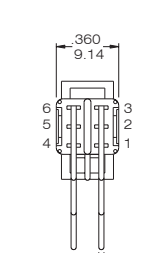
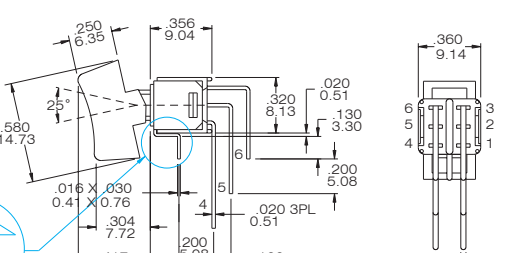
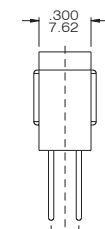

RS-9 - R1-2-Q / RS-9-R1-2-Q-S

Actuator Option

Actuator Color Option

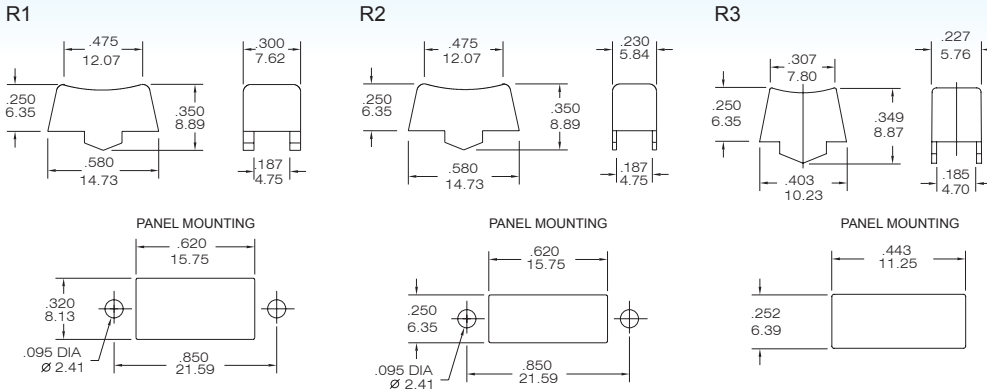

Code	Color
1	White
2	Black(std.)
3	Red

Other colors, customized actuator marking available consult factory.

TERMINAL OPTION (ONLY FOR THE RS-4/RS-5)

B Solder Lug(STD)

C PRINTED CIRCUIT

D Wire Wrap

DPDT

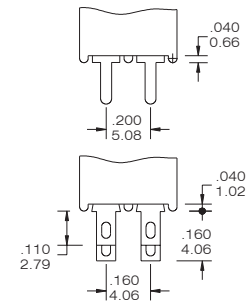
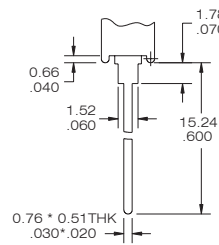
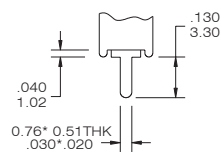
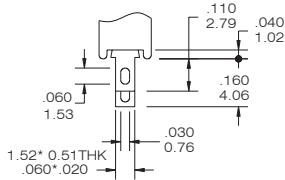

CONTACT MATERIAL OPTIONS

CODE	CONTACT MATERIAL	TERMINAL MATERIAL	RATING
Q	Silver plated	Silver plated	3 A @ 120V AC or 28 V DC; 1.5 A @ 250 VAC
R	Gold plated over nickel plated	Gold plated over nickel plated	0.4VA MAX @ 20 V AC or DC MAX
G	Gold plated over silver plated	Gold plated over silver plated	0.4 VA MAX @ 20 V AC or DC MAX or 3 A @ 120V AC or 28 V DC; 1.5 A @ 250 VAC
K	Gold plated over nickel plated	Tin over nickel plated	0.4VA MAX @ 20 V AC or DC MAX

* THE K option is only for some special item. Please inquire first when you need the "K" option

P.C.B MOUNTING DIMENSION

RS-4 (PC terminal)

RS-6

RS-8

RS-5 (PC terminal)

RS-7

RS-9

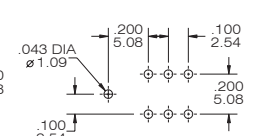
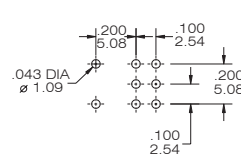
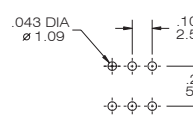
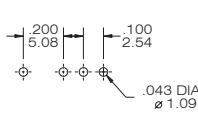
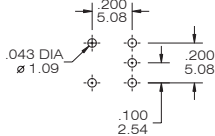
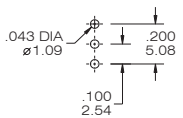

VERTICAL SUPPORT BRACKET OPTION

only for the RS-4/RS-5 . If you need the vertical support bracket , please build the terminal option is "C" code

A5/ A5S

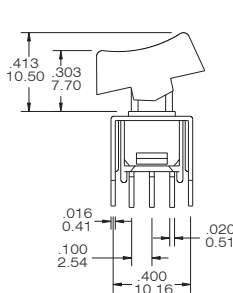
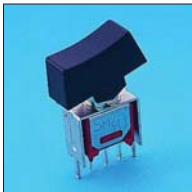

A5 (STD.)

A5S (Snap-in)

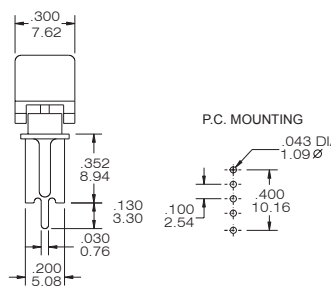

RS-4-R1-2-CQ-A5

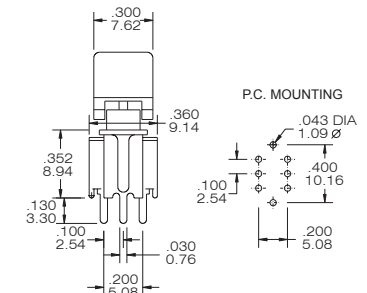

RS-5-R1-2-CQ-A5