

SHOGYO INTERNATIONAL CORP.

www.shogyo.com

SPEAKER SPECIFICATIONS

MODEL NO.	GC0351NX (RoHS)				
1	NOMINAL SIZE	35 x 16 mm			
2	IMPEDANCE	8 Ω ± 15%			
3	RESONANCE FO	650 Hz ± 130 Hz			
4	OUTPUT S.P.L.	82 dB/w ± 3 dB	1 w 50 cm average at		
5	FREQ. RESPONSE	Fo Hz ~ 5K Hz			
6	INPUT POWER	Rated power 1 W	Max power 2 W		
7	OPERATION	Must be normal at program source 1 W			
8	BUZZ. RATTLE, ETC.	Must be normal at Sine Wave 2.83 V			
9	FLUX DENSITY	Gauss ± 10%			
10	MAGNET	NdFeB φ7.9x1.0H mm			
11	TOTAL WEIGHT	2 grams			
12	DISTORTION	5% MAX at 1K Hz 1 W			
13	LOAD TEST	Must be normal White noise 1 W. 24 Hours at 25°C (room temp.)			
14	OPERATION TEMP.	Must be normal -25 °C ~ +60 °C			
15	HEAT TEST	Must be normal 60±2 °C 20-50 % R.H. 24 Hours			
16	HUMIDITY TEST	Must be normal 40±2 °C 90-95 % R.H. 24 Hours			

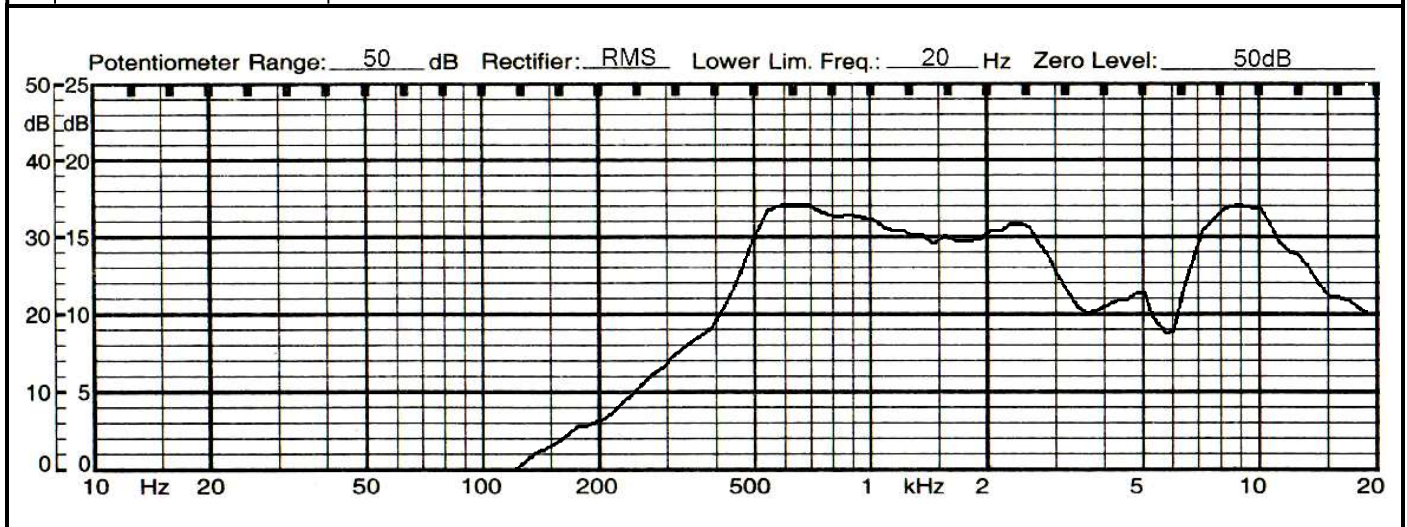

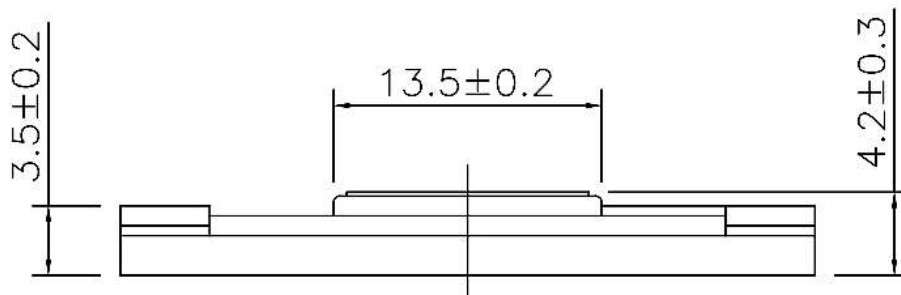
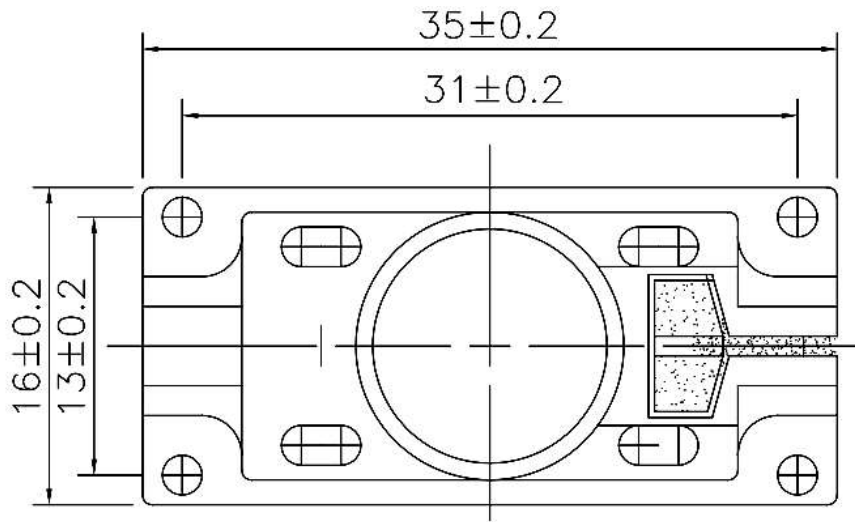

Mouting Notice:

At least 1 m/m for diaphragm moving

	MODEL NO.		
	GC0351NX		
Unit: mm Tol.: ±0.3	APPROVED	CHECKED	DRAWED