

# SHOGYO INTERNATIONAL CORP.

www.shogyo.com

## SPEAKER SPECIFICATIONS

MODEL NO.		GC0231MX (RoHS)				
1	NOMINAL SIZE	23 mm				
2	IMPEDANCE	32 $\Omega$ $\pm$ 15%		at. 1K Hz 1 V		
3	RESONANCE FO	600 Hz $\pm$ 120 Hz		FO Hz 1 V		
4	OUTPUT S.P.L.	74 dB/w $\pm$ 3 dB		0.1 W 50 cm average at 800, 1K, 1.2K, 1.5K Hz		
5	FREQ. RESPONSE	Fo Hz ~ 5K Hz      Max 10 dB				
6	INPUT POWER	Rated power 0.1 W		Max power 0.2 W		
7	OPERATION	Must be normal at program source 0.1 W				
8	BUZZ, RATTLE, ETC.	Must be normal at Sine Wave 1.8 V				
9	MAGNET	9.5 x 1.5 mm				
10	FLUX DENSITY	Gauss $\pm$ 10%		total flux max well within		
11	DISTORTION					
12	LOAD TEST	After test meet Item 7 and 8		White noise 0.1 W 24 Hours		
13	OPERATION TEMP.					
14	HEAT TEST	After test meet Item 7 and 8		60 $\pm$ 2° C 20-50 %R.H. 24 Hours		
15	HUMIDITY TEST	After test meet Item 7 and 8		40 $\pm$ 2° C 90-95 % R.H. 24 Hours		

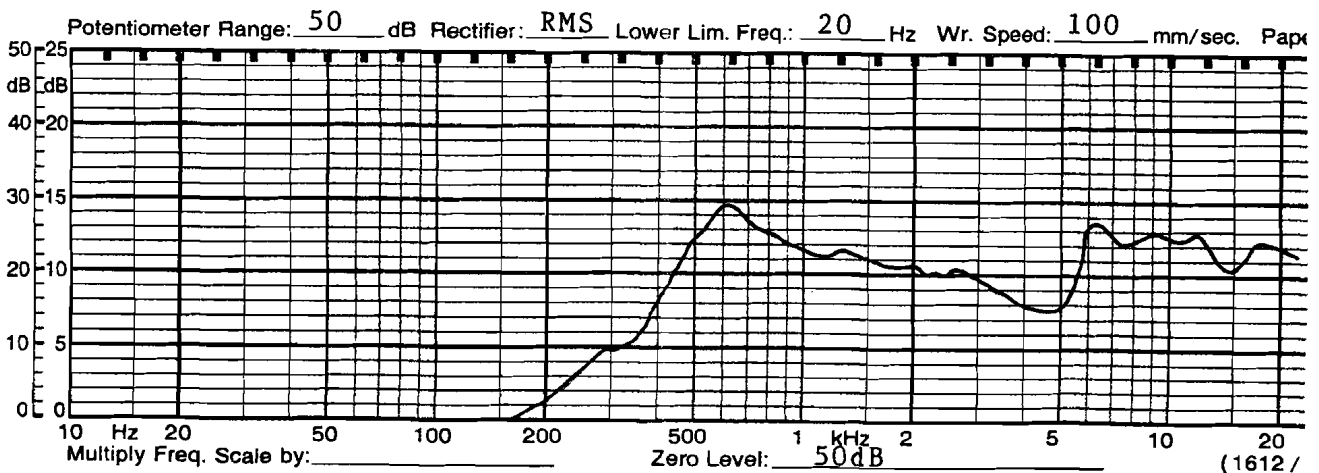

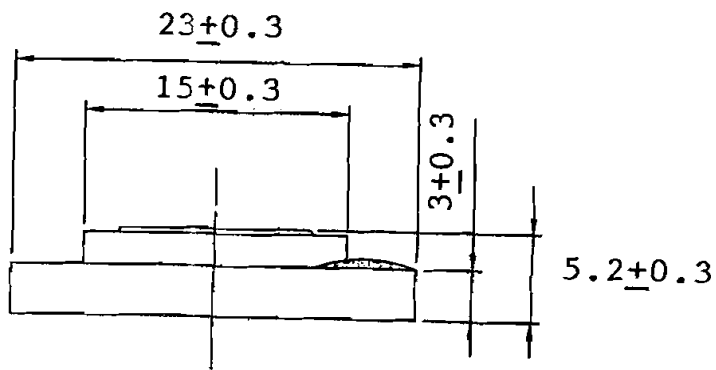
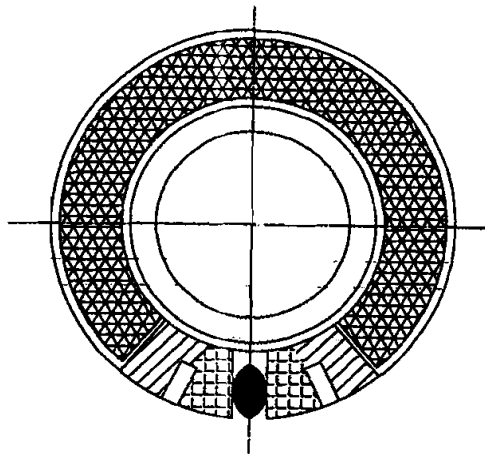

MODEL NO.

**GC0231MX**

APPROVED

CHECKED

DRAWING