

# SHOGYO INTERNATIONAL CORP.

www.shogyo.com

## SPEAKER SPECIFICATIONS

<b>MODEL NO.</b>	<b>GF0777B-2X (RoHS)</b>				
<b>1</b>	<b>NOMINAL SIZE</b>	<b>80 mm</b>	<b>3</b>	<b>inch</b>	
<b>2</b>	<b>IMPEDANCE</b>	<b>8 <math>\Omega</math> <math>\pm</math> 15%</b>	<b>at. 800 Hz</b>	<b>1 V</b>	
<b>3</b>	<b>RESONANCE FO</b>	<b>150 Hz <math>\pm</math> 30 Hz</b>	<b>FO Hz</b>	<b>1 V</b>	
<b>4</b>	<b>S.P. LEVEL</b>	<b>90 dB/w <math>\pm</math> 3 dB</b>	<b>1 W 50 cm average at</b>		
<b>5</b>	<b>FREQ. RESPONSE</b>	<b>Fo Hz ~ 18K Hz</b>			
<b>6</b>	<b>INPUT POWER</b>	<b>Nominal Input 5 W</b>	<b>Handling Capacity 8 W</b>		
<b>7</b>	<b>OPERATION</b>	<b>Must be normal at program source 5 W</b>			
<b>8</b>	<b>BUZZ, RATTLE, ETC.</b>	<b>Must be normal at Sine Wave 6.3 V</b>			
<b>9</b>	<b>MAGNET</b>	<b>45 x 22 x 8 mm</b>			
<b>10</b>	<b>TOTAL WEIGHT</b>	<b>135 grams</b>			
<b>11</b>	<b>DISTORTION</b>	<b>10% MAX at 1K Hz 1 W</b>			
<b>12</b>	<b>LOAD TEST</b>	<b>Must be normal White Noise 5 W 24 Hourse at 25°C (room temperature)</b>			
<b>13</b>	<b>OPERATION TEMP.</b>	<b>Must be normal -25°C +60°C 4 Hours</b>			
<b>14</b>	<b>HEAT TEST</b>	<b>After test meets Item 7 and 8 60 <math>\pm</math> 2° C 20-50 % R.H. 24 Hours</b>			
<b>15</b>	<b>HUMIDITY TEST</b>	<b>After test meet Item 7 and 8 40 <math>\pm</math> 2° C 90-95 % R.H. 24 Hours</b>			

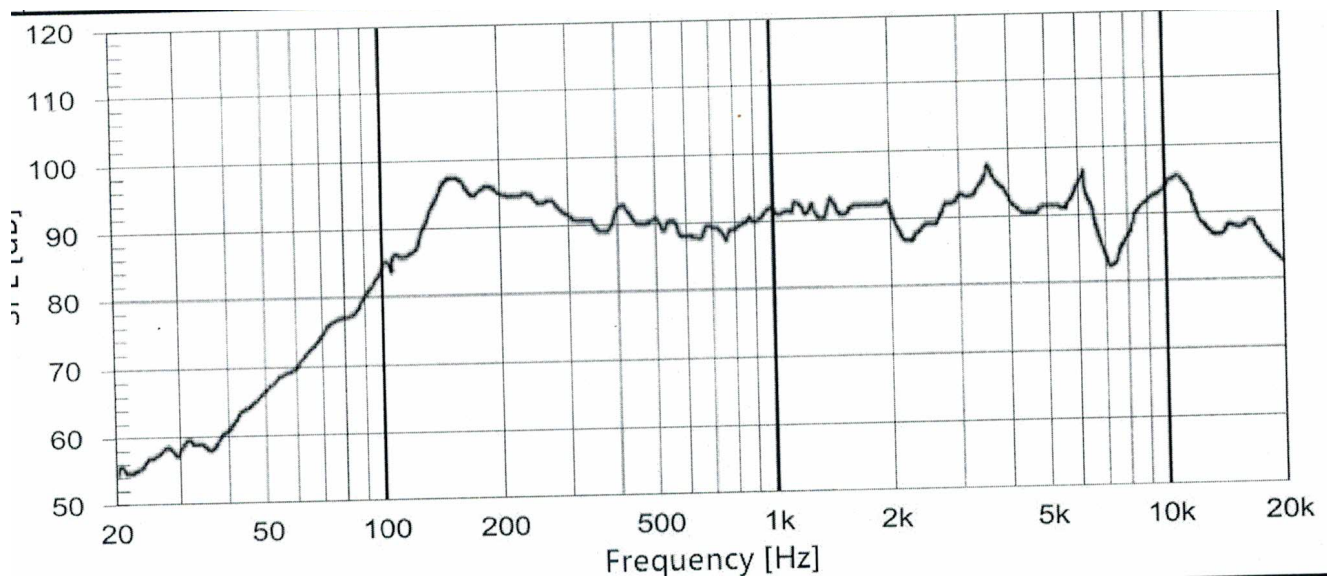

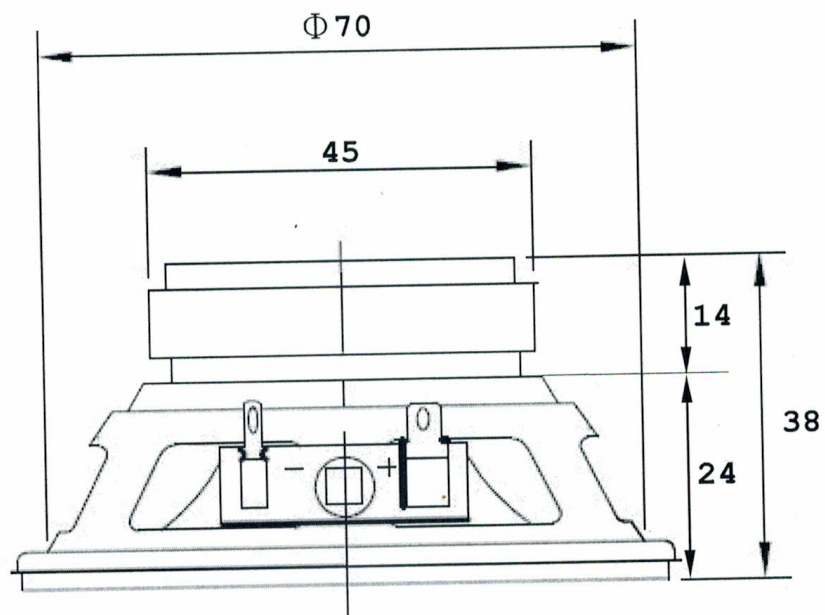
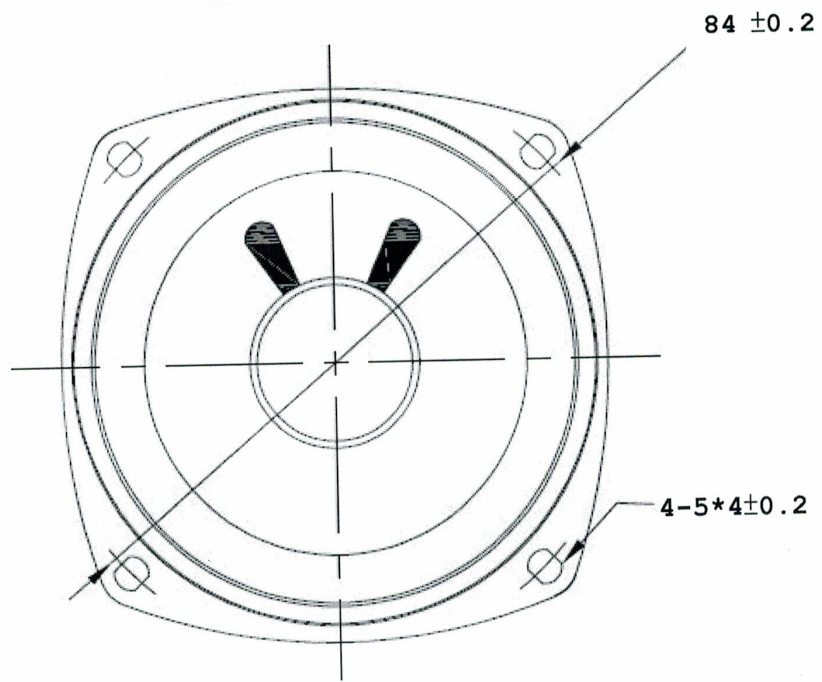

**MODEL NO. GF0777B-2X**

APPROVED	CHECKED	DRAWING