

SPECIFICATIONS

RATING: 50mA, 36VDC
 ELECTRICAL LIFE: 100,000 cycles
 CONTACT RESISTANCE: 60mΩ max
 INSULATION RESISTANCE: 100MΩ min. 250VDC
 DIELECTRIC STRENGTH: 250VAC/1 min
 OPERATION FORCE: 100gf, 160gf, 260gf

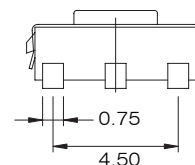
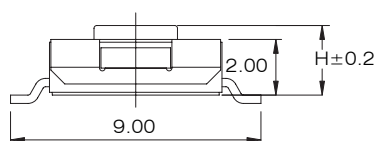
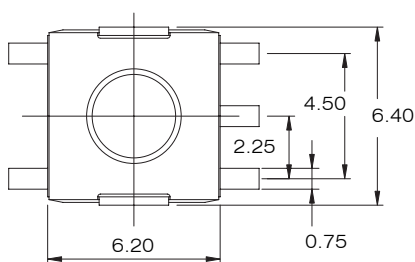

ELTSMC-62	3.1
ELTSMC-61	2.5
PROD. NO.	H

P.C.B LAYOUT

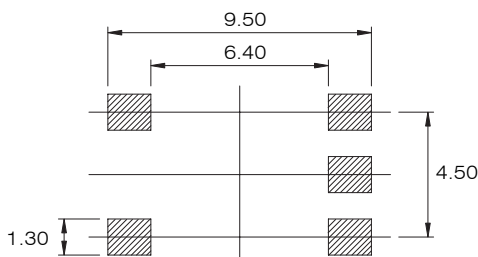

CIRCUIT

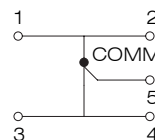

HOW TO ORDER

ELTSMC - 6 1 - K □ - □ - H

Function: SPDT, ON-ON

Height:
 1 = 2.5mm
 2 = 3.1mm

Color Of Stem For Operation Force (standard type):
 K = Black 100g
 N = Brown 160g
 R = Red 260g

H = RoHS compliant

Package style:
 □ = Bag

Operation Force: (non-standard type)
 □ = Regular type
 K = 100g
 N = 160g
 R = 260g

INDEX
 TOGGLE
 ROCKER
 SLIDE
 PUSH BUTTON
 DIP
 TACT